

Mounting plate angle for roof mount antennas



- **Our products are RoHS- and REACH-conform**
- **Roof antenna mounted waterproof IP69K**
- **Cable entrance also waterproof**
- **Mounting plate for mounting in free space**



Mechanical Data

Dimensions (LxBxH)	ca. 86 mm x 102 mm x 2 mm
Mounting bore hole	Ø 16mm (+2mm/-0mm)
Tightening torque	4 Nm to max. 6 Nm (plastic diecast) 12 Nm to max. 15 Nm (aluminium diecast)

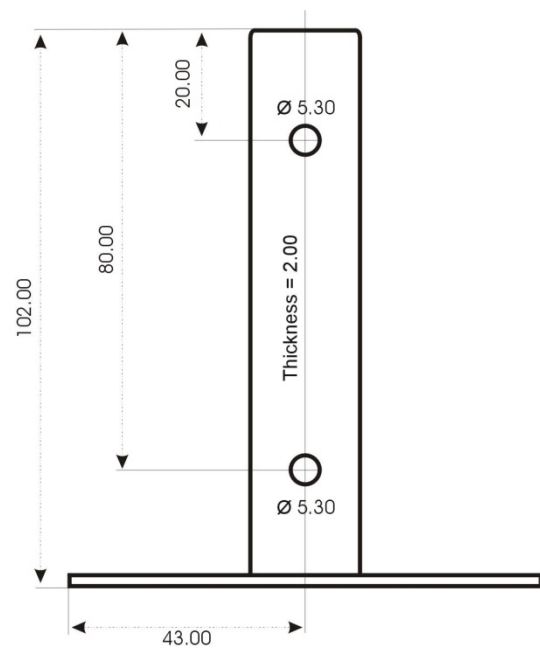
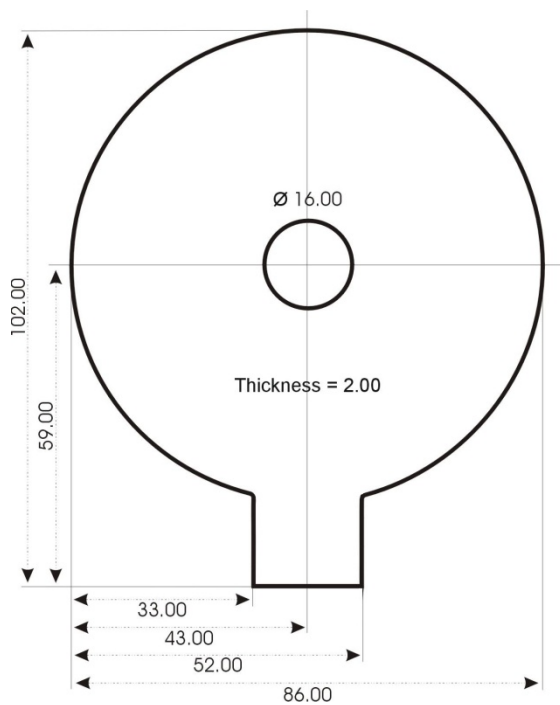

All dimensions in „mm“

Mounting Instructions

- Please note that the cable entrance of the roof mount antenna should be waterproof (ask us!).
- Remove screw nut and washer from the cable, leave o-ring on the antenna.
- Plug cable through the hole, also the screw thread.
- Now the washer and the screw nut have to put back on the cable and the thread.
- Tightening torque on M16 nut is min. 4Nm to max. 6Nm.
- Alternatively the bottom is available as aluminum diecast with tightening torque 12 Nm to max. 15 Nm (AL).

Warranty

The lawful warranty conditions apply.